



SIRIUS SOFT STARTER, SIZE S00, 17.6A,  
7.5KW/400V, 40 DEGREES, 200-480V AC, 110-230V  
AC/DC, SCREW TERMINALS

General technical data:

|  |  |        |
|--|--|--------|
| <b>product brand name</b>  |  | SIRIUS |
| <ul style="list-style-type: none"> <li>• Product equipment Integrated bypass contact system</li> </ul> |  | Yes    |
| <ul style="list-style-type: none"> <li>• Product feature Thyristors</li> </ul>                         |  | Yes    |
| <b>Product function</b>  |  |        |
| <ul style="list-style-type: none"> <li>• Intrinsic device protection</li> </ul>                        |  | No     |
| <ul style="list-style-type: none"> <li>• motor overload protection</li> </ul>                          |  | No     |
| <ul style="list-style-type: none"> <li>• Evaluation of thermistor motor protection</li> </ul>          |  | No     |
| <ul style="list-style-type: none"> <li>• External reset</li> </ul>                                     |  | No     |
| <ul style="list-style-type: none"> <li>• Adjustable current limitation</li> </ul>                      |  | No     |
| <ul style="list-style-type: none"> <li>• Inside-delta circuit</li> </ul>                               |  | No     |
| <b>Product component Motor brake output</b>  |  | No     |
| <b>Equipment marking acc. to DIN EN 61346-2</b>  |  | Q      |
| <b>Equipment marking acc. to DIN 40719 extended according to IEC 204-2 acc. to IEC 750</b>             |  | G      |

Power Electronics:

|                            |  |   |
|----------------------------|--|---|
| <b>Product designation</b> |  | soft starters for standard applications |
|----------------------------|--|---|

|   |    |             |
|---|----|-------------|
| <b>Operating current</b>  |    |             |
| • at 40 °C rated value  | A  | 17.6        |
| • at 50 °C rated value  | A  | 17          |
| • at 60 °C rated value  | A  | 14          |
| <b>Mechanical power output for three-phase motors</b>   |    |             |
| • at 230 V  |    |             |
| — at standard circuit at 40 °C rated value  | W  | 4 000       |
| • at 400 V  |    |             |
| — at standard circuit at 40 °C rated value  | W  | 7 500       |
| <b>Yielded mechanical performance [hp] for three-phase AC motor at 200/208 V at standard circuit at 50 °C rated value</b> | hp | 3           |
| Operating frequency rated value   | Hz | 50 ... 60   |
| <b>Relative negative tolerance of the operating frequency</b>   | %  | -10         |
| <b>Relative positive tolerance of the operating frequency</b>   | %  | 10          |
| Operating voltage at standard circuit rated value   | V  | 200 ... 480 |
| <b>Relative negative tolerance of the operating voltage at standard circuit</b>   | %  | -15         |
| <b>Relative positive tolerance of the operating voltage at standard circuit</b>   | %  | 10          |
| <b>Minimum load [% of IM]</b>   | %  | 10          |
| <b>Continuous operating current [% of I<sub>e</sub>] at 40 °C</b>   | %  | 115         |
| <b>Power loss [W] at operating current at 40 °C during operation typical</b>  | W  | 4           |

#### Control electronics:

|   |    |             |
|---|----|-------------|
| <b>Type of voltage of the control supply voltage</b>                            |    | AC/DC       |
| <b>Control supply voltage frequency 1 rated value</b>                           | Hz | 50          |
| <b>Control supply voltage frequency 2 rated value</b>                           | Hz | 60          |
| <b>Relative negative tolerance of the control supply voltage frequency</b>      | %  | -10         |
| <b>Relative positive tolerance of the control supply voltage frequency</b>      | %  | 10          |
| <b>Control supply voltage 1 at AC at 50 Hz</b>                                  | V  | 110 ... 230 |
| <b>Control supply voltage 1 at AC at 60 Hz</b>                                  | V  | 110 ... 230 |
| <b>Relative negative tolerance of the control supply voltage at AC at 60 Hz</b> | %  | -20         |
| <b>Relative positive tolerance of the control supply voltage at AC at 60 Hz</b> | %  | 20          |
| <b>Control supply voltage 1 at DC</b>   | V  | 110 ... 230 |
| <b>Relative negative tolerance of the control supply voltage at DC</b>          | %  | -20         |
| <b>Relative positive tolerance of the control supply voltage at DC</b>          | %  | 20          |

|                                  |  |     |
|----------------------------------|--|-----|
| Display version for fault signal |  | red |
|----------------------------------|--|-----|

### Mechanical data:

|   |    |  |
|---|----|--|
| Size of engine control device                   |    | S00  |
| Width   | mm | 45   |
| Height  | mm | 95   |
| Depth   | mm | 150  |
| Mounting type                                   |    | screw and snap-on mounting   |
| Mounting position                               |    | With vertical mounting surface +/-10° rotatable, with vertical mounting surface +/- 10° tiltable to the front and back |
| Required spacing with side-by-side mounting     |    |  |
| • upwards                                       | mm | 60   |
| • at the side                                   | mm | 15   |
| • downwards                                     | mm | 40   |
| Installation altitude at height above sea level | m  | 5 000  |
| Wire length maximum                             | m  | 300  |
| Number of poles for main current circuit        |    | 3  |

### Connections/ Terminals:

|  |  |  |
|--|--|--|
| Type of electrical connection  |  |  |
| • for main current circuit   |  | screw-type terminals   |
| • for auxiliary and control current circuit  |  | screw-type terminals   |
| Number of NC contacts for auxiliary contacts   |  | 0  |
| Number of NO contacts for auxiliary contacts   |  | 1  |
| Number of CO contacts for auxiliary contacts   |  | 0  |
| Type of connectable conductor cross-sections for main contacts for box terminal using the front clamping point |  |  |
| • solid  |  | 2x (1 ... 2.5 mm <sup>2</sup> ), 2x (2.5 ... 6 mm <sup>2</sup> )   |
| • finely stranded with core end processing   |  | 2x (1.5 ... 2.5 mm <sup>2</sup> ), 2x (2.5 ... 6 mm <sup>2</sup> ) |
| Type of connectable conductor cross-sections at AWG conductors for main contacts for box terminal              |  |  |
| • using the front clamping point   |  | 2x (16 ... 10)   |
| Type of connectable conductor cross-sections for auxiliary contacts  |  |  |
| • solid  |  | 2x (0.5 ... 2.5 mm <sup>2</sup> )                                  |
| • finely stranded with core end processing   |  | 2x (0.5 ... 1.5 mm <sup>2</sup> )                                  |
| Type of connectable conductor cross-sections at AWG conductors   |  |  |
| • for auxiliary contacts   |  | 2x (20 ... 14)   |
| • for auxiliary contacts finely stranded with core end processing  |  | 2x (20 ... 16)   |

### Ambient conditions:

|                     |  |  |
|---------------------|--|--|
| Ambient temperature |  |  |
|---------------------|--|--|

|                             |    |             |
|-----------------------------|----|-------------|
| • during operation          | °C | -25 ... +60 |
| • during storage            | °C | -40 ... +80 |
| <b>Derating temperature</b> | °C | 40          |
| <b>Protection class IP</b>  |    | IP20        |

Certificates/ approvals:

|  |  |   |
|--|--|---|
| <b>General Product Approval</b>  | <b>EMC</b>   | <b>Declaration of Conformity</b>  |
| <br>CCC | <br>UL  | <br>EG-Konf. |
| <br>CSA | <br>EAC | <br>C-TICK   |

|   |   |
|---|---|
| <b>Test Certificates</b>                          | <b>other</b>  |
| <a href="#">Typprüfbescheinigung/Werkszeugnis</a> | <a href="#">Umweltbestätigung</a> <a href="#">sonstig</a> <a href="#">Bestätigungen</a> |

UL/CSA ratings:

|  |    |             |
|--|----|-------------|
| <b>Yielded mechanical performance [hp] for three-phase AC motor</b>  |    |             |
| <ul style="list-style-type: none"> <li>• at 220/230 V             <ul style="list-style-type: none"> <li>— at standard circuit at 50 °C rated value</li> </ul> </li> <li>• at 460/480 V             <ul style="list-style-type: none"> <li>— at standard circuit at 50 °C rated value</li> </ul> </li> </ul> | hp | 3<br><br>10 |
| <b>Contact rating of auxiliary contacts according to UL</b>  |    | B300 / R300 |

Further information

- Simulation Tool for Soft Starters (STS)**  
<https://support.industry.siemens.com/cs/ww/en/view/101494917>
- Information- and Downloadcenter (Catalogs, Brochures,...)**  
<http://www.siemens.com/industrial-controls/catalogs>
- Industry Mall (Online ordering system)**  
<http://www.siemens.com/industrymall>
- Cax online generator**  
<http://support.automation.siemens.com/WW/CAXorder/default.aspx?lang=en&mlfb=3RW30181BB14>
- Service&Support (Manuals, Certificates, Characteristics, FAQs,...)**  
<https://support.industry.siemens.com/cs/ww/en/ps/3RW30181BB14>
- Image database (product images, 2D dimension drawings, 3D models, device circuit diagrams, EPLAN macros, ...)**  
[http://www.automation.siemens.com/bilddb/cax\\_de.aspx?mlfb=3RW30181BB14&lang=en](http://www.automation.siemens.com/bilddb/cax_de.aspx?mlfb=3RW30181BB14&lang=en)

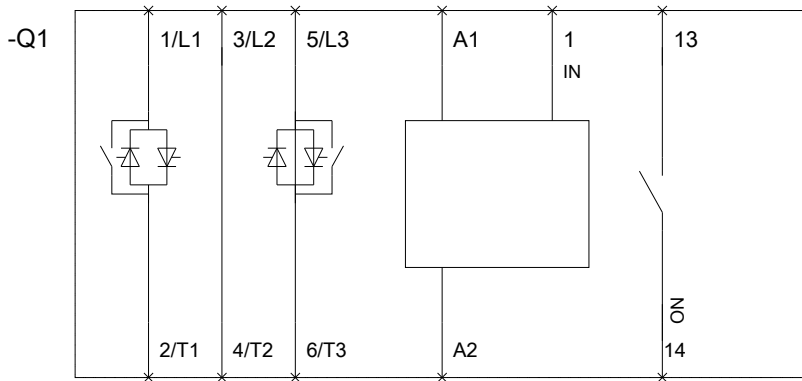
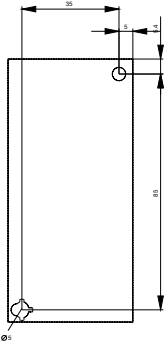
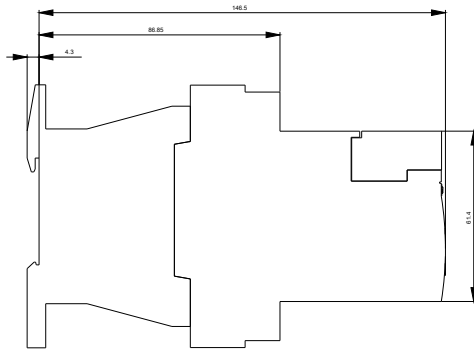
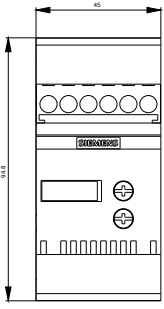

last modified:

04.06.2016