



PTP-1L HP&MP&LP Portable Gas & liquid SRV Test Bench



1、Features:

- 1.1 Able for set pressure test and seat tightness test for all types of SRV, clamping bench can be used for quick and safe clamping of all conceivable types of safety or relief valves according to common international test standard-API526, API527, ANSI/API RP576.
- 1.2 Connected to a nitrogen cylinder and other testing gas, equipped with a liquid tank and manual liquid booster pump, used for checking safety valves with gas and liquid .
- 1.3 Manual clamping, no use by electricity.
- 1.4 Small size, light weight, easy to carry, convenient for carrying to any factory site.

2、Technical specifications:

Max.test pressure:	Gas: 15MPa	
	Liquid: 30MPa	
Clamping range:	Flanged: DN15-150(1/2" -6")	<input checked="" type="checkbox"/> Threaded: DN15-50(1/2" -2")
Clamping force:	6T, Manual clamping	
Test medium:	Nitrogen, compressed air ,water	
Maximum height under the claws:	60mm	
Clampable min. flange outer diameter:	75mm	
Clampable max. flange outer diameter:	300mm	
Power request:	Test gas source: bottled nitrogen ($\leq 15\text{MPa}$).	

Clamping seat:	Single seat
----------------	-------------

3、Clamping force comparison table:

Clamping range mm(in)	Max. test pressure	
	DN15-25(1/2"-1")	30MPa/4350psi
	DN32-40(1 1/4"-1 1/2")	18MPa/2610psi
	DN50-65(2"-2 1/2")	9MPa/1305psi

4、Schematic diagram:

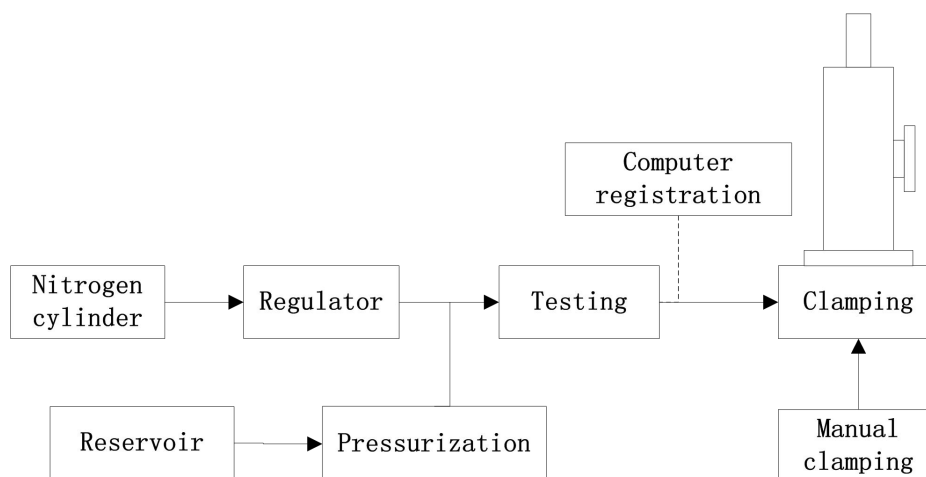

5、Dimensions and weight:

Dimensions and weight	983*530*342, 48KG
-----------------------	-------------------

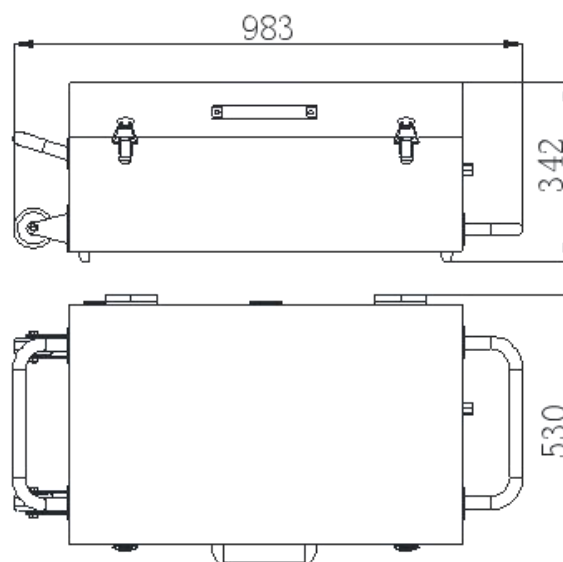

6、 Supply scope table:

S/N	Name	Description	Qty
6.1	Portable Safety Valve Test Bench	Max.test air pressure 15MPa , max.test liquid pressure please check “2、 Technical specifications”, max. manual clamping force 6T, clamping range DN15-65	1pcs
6.2	Precision pressure gauge	Radial pointer with a measuring range of 16MPa , digital precision pressure gauge	1pcs of each
6.3	Standard configuration	Please see “7、 standard configuration”	1set
6.4	Optional configuration	Please check “8、 Optional configuration”	Follow your needs
6.5	Mounting accessories	Pipeline connections for safety valve test bench	1set
6.6	Documents	Three equipment operation manual, one equipment factory quality certificate, one clamping force comparison table, one pump maintenance manual , one packing list	1set

7、 Standard configuration:

S/N	Description	Qty
7.1	Nitrogen cylinder hose (L=3m)	1pcs
7.2	O-ring for test	2set
7.3	liquid inlet hose and outlet hose (L=5m)	1pcs of each
7.4	Funnel (for adding water to water tank)	1pcs
7.5	Flange-thread transition plate(Φ 160mm)	1pcs
7.6	Tool kit	1pcs
7.7	Threaded safety valve adapter, each 1pcs from DN15-50	Total 6pcs